

END ELEVATION
PRECAST CONCRETE GALLERY
NOT TO SCALE

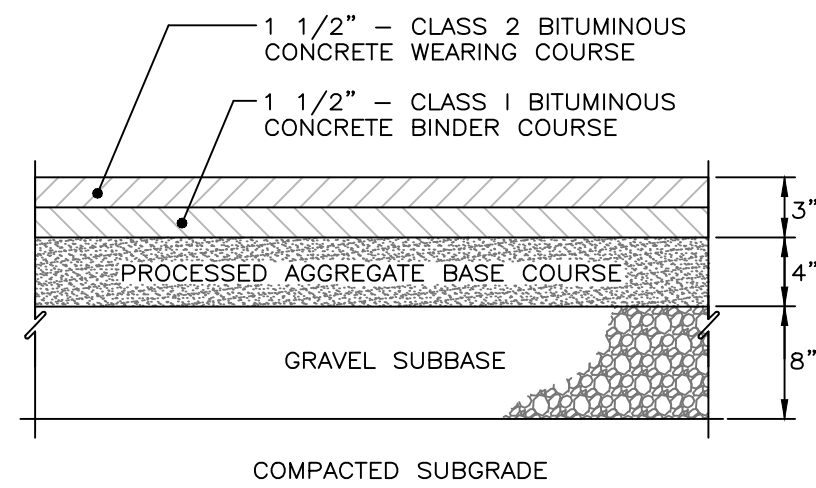

TYPICAL PAVEMENT SECTION
NOT TO SCALE

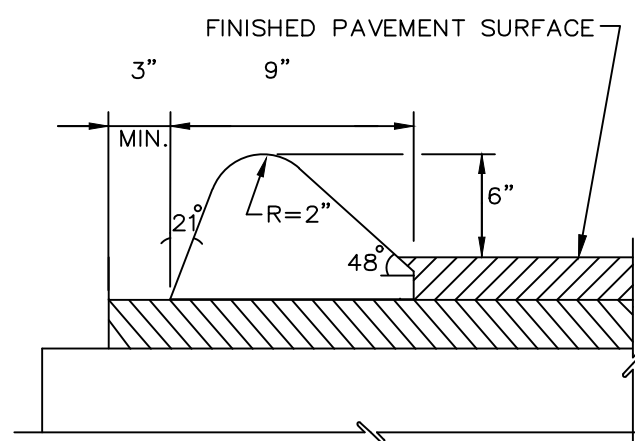

SECTION
BITUMINOUS CONCRETE LIP CURBING
NOT TO SCALE

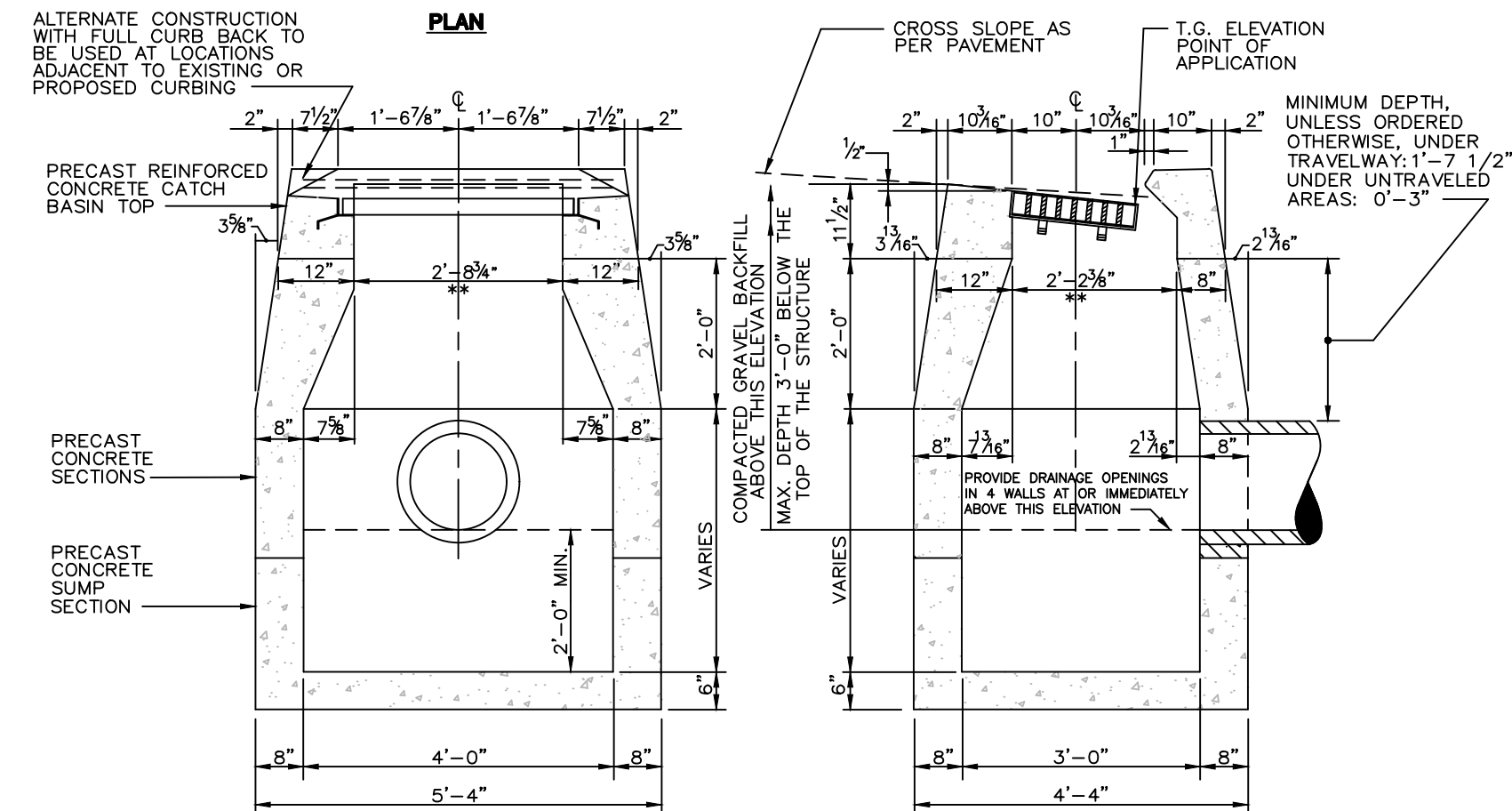

- NOTES:
1. C.T.D.T. STANDARD 507K GALVANIZED STEEL FRAMES AND GRATES. ALL GRATES SHALL BE TYPE A.
 2. WHERE DIRECTED BY THE ENGINEER SET SUMP SECTION ON A 12" THK. BASE OF COMPACTED 3/4" CRUSHED STONE IN GEOTEXTILE ENVELOPE.
 3. THE TOP OF THE SUMP SECTION SHALL BE AT LEAST 6" BELOW THE BOTTOM OF THE PIPE OUTLETTING FROM THE CATCH BASIN.
 4. WALL THICKNESS OF CATCH BASINS OVER 10 FEET DEEP SHALL BE INCREASED TO 12". INSIDE DIMENSIONS TO REMAIN THE SAME.

TYPE "C" CATCH BASIN
NOT TO SCALE

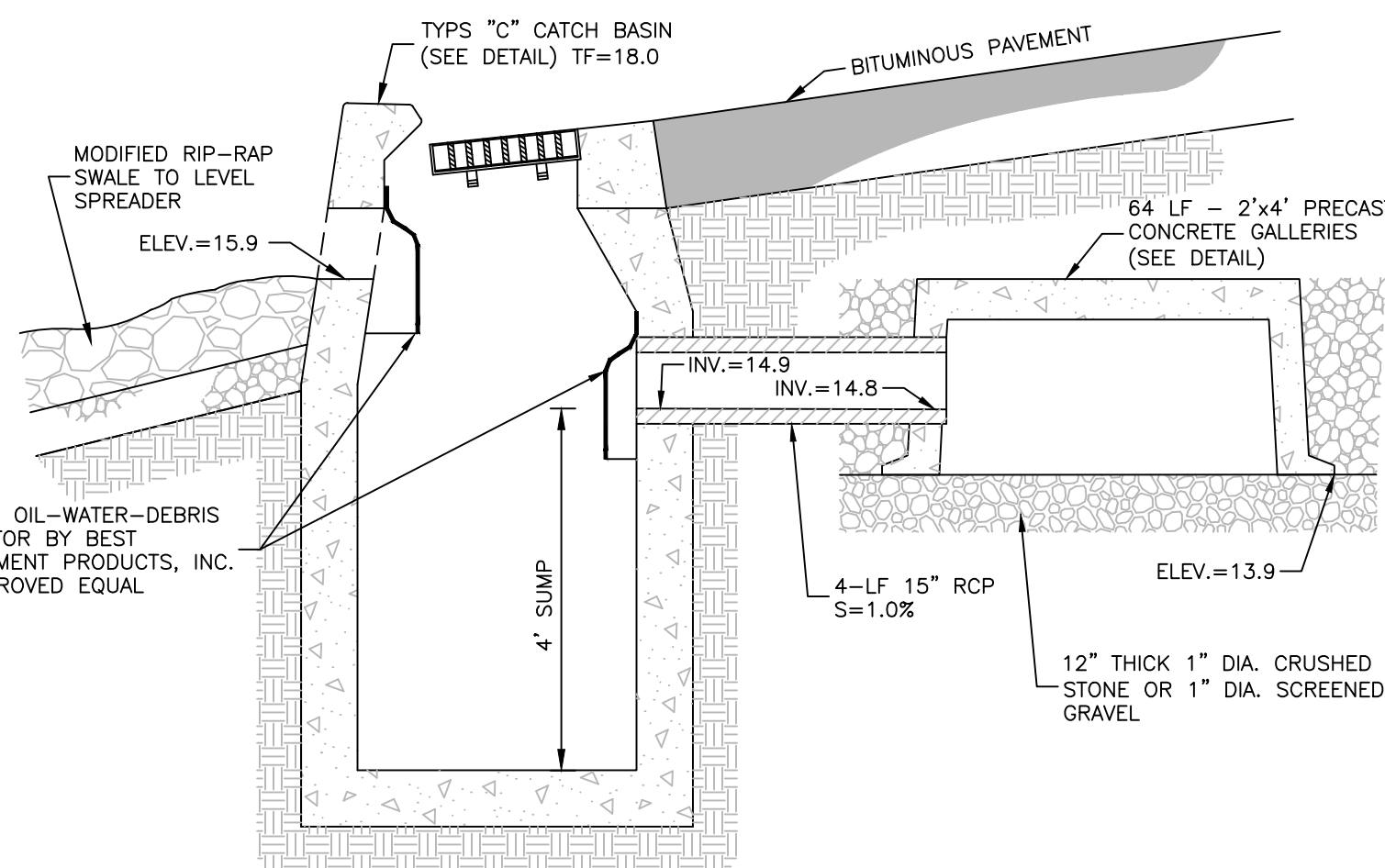

STORMWATER DETENTION INLET/OUTLET STRUCTURE
NOT TO SCALE

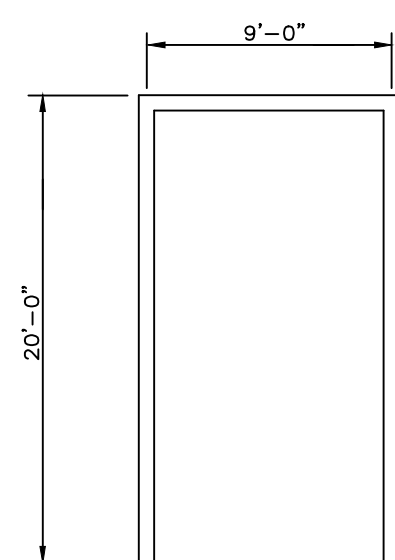

TYPICAL PARKING SPACE
NOT TO SCALE

- NOTES:
1. ALL PAINTED AISLE LINES SHALL BE 4" WIDE. COLOR-WHITE.
 2. ELIMINATE PAINTED LINES ADJACENT TO CURBING.

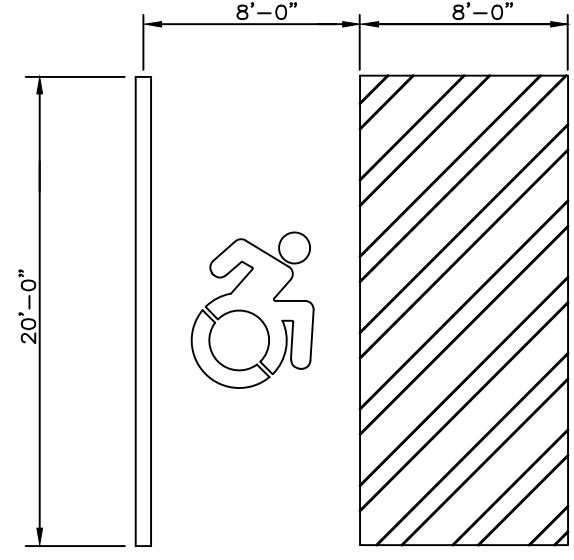

VAN ACCESSIBLE PARKING SPACE
NOT TO SCALE

- NOTES:
1. ALL PAINTED AISLE LINES SHALL BE 4" WIDE. COLOR-WHITE.
 2. ALL PAINTED CROSS HATCHED AISLE MARKINGS AND ACCESSIBLE SYMBOL MARKINGS SHALL BE COLOR-WHITE.

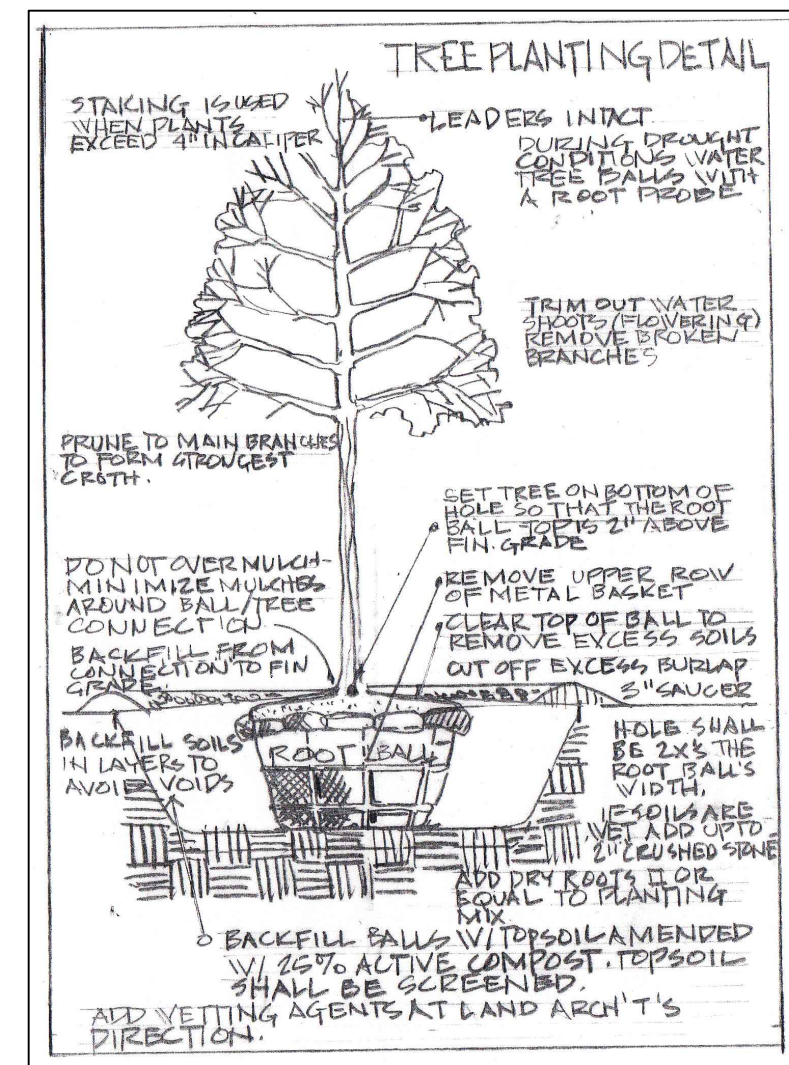

ACCESSIBLE PARKING SIGN/BOLLARD
NOT TO SCALE

- NOTES:
1. ALL SIGNS TO HAVE ENGINEER GRADE PRISMATIC REFLECTIVE SIGN FACE.
 2. SIGNS SHALL HAVE WHITE LETTERING ON BLUE BACKGROUND.
 3. SIGN LEGEND TO BE IN ACCORDANCE WITH CORRECT STATE OF CONNECTICUT STANDARDS.

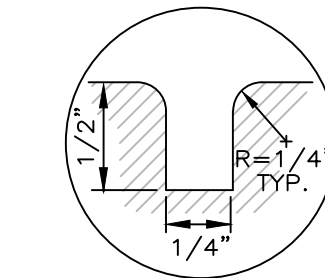

TROWELED JOINT DETAIL

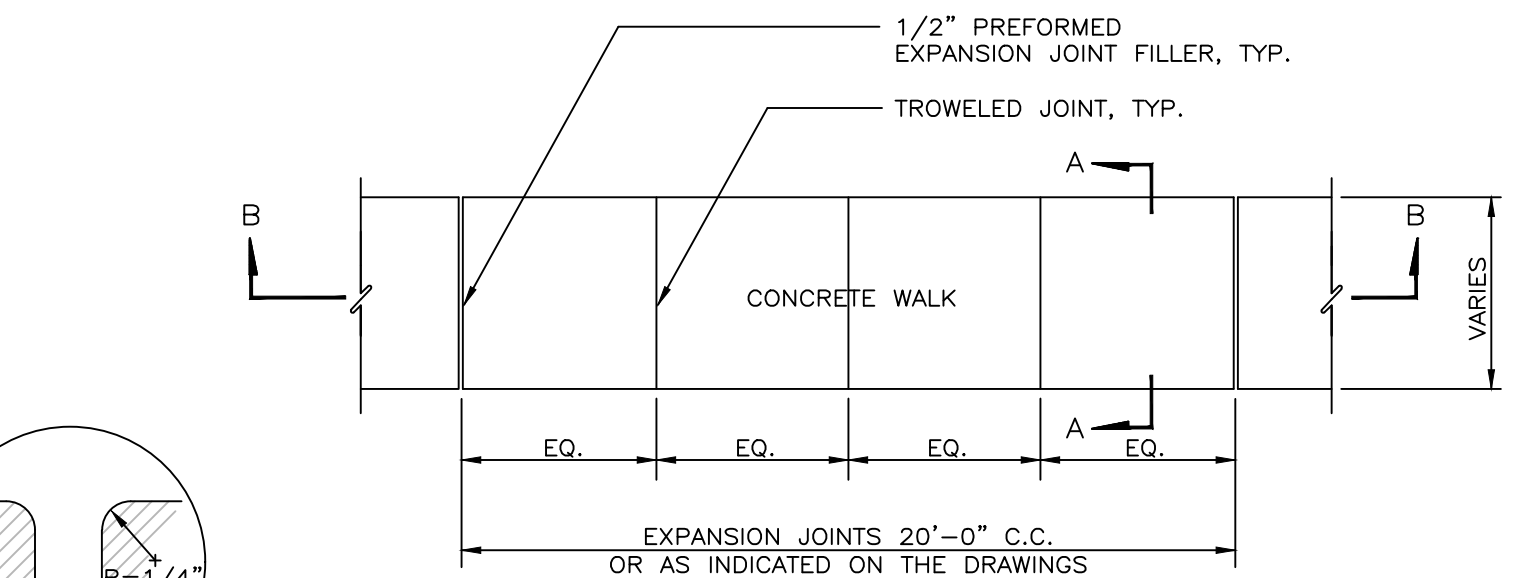

PLAN

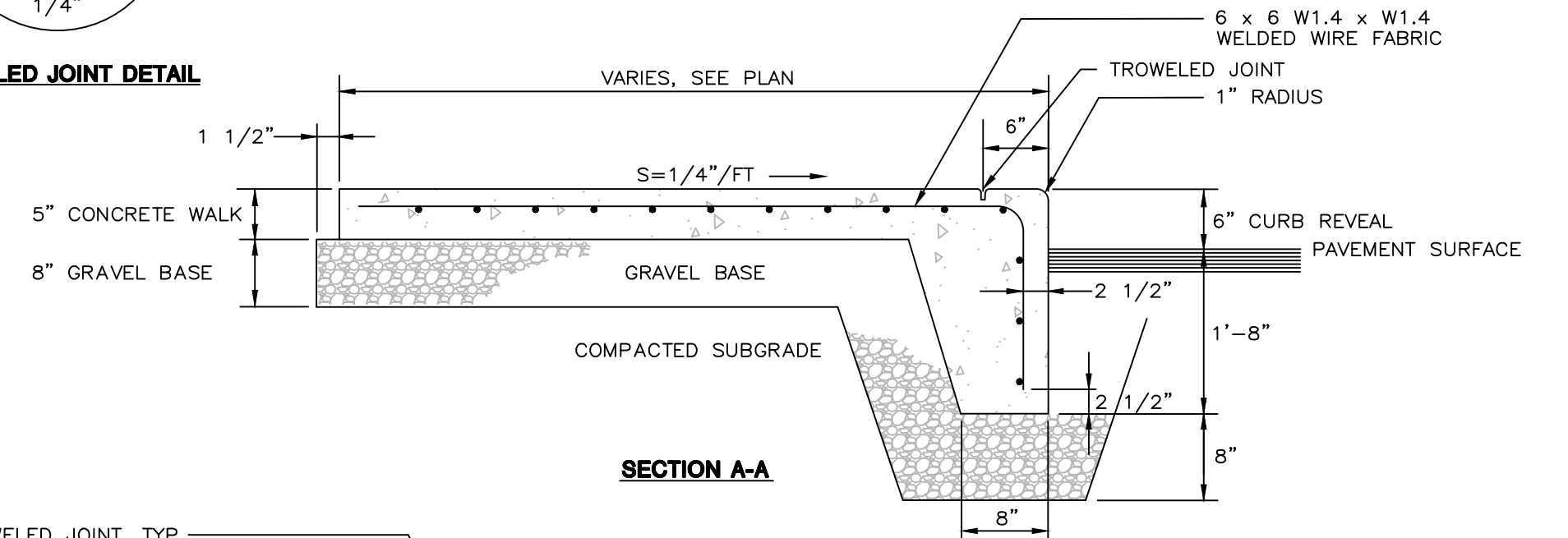

SECTION A-A

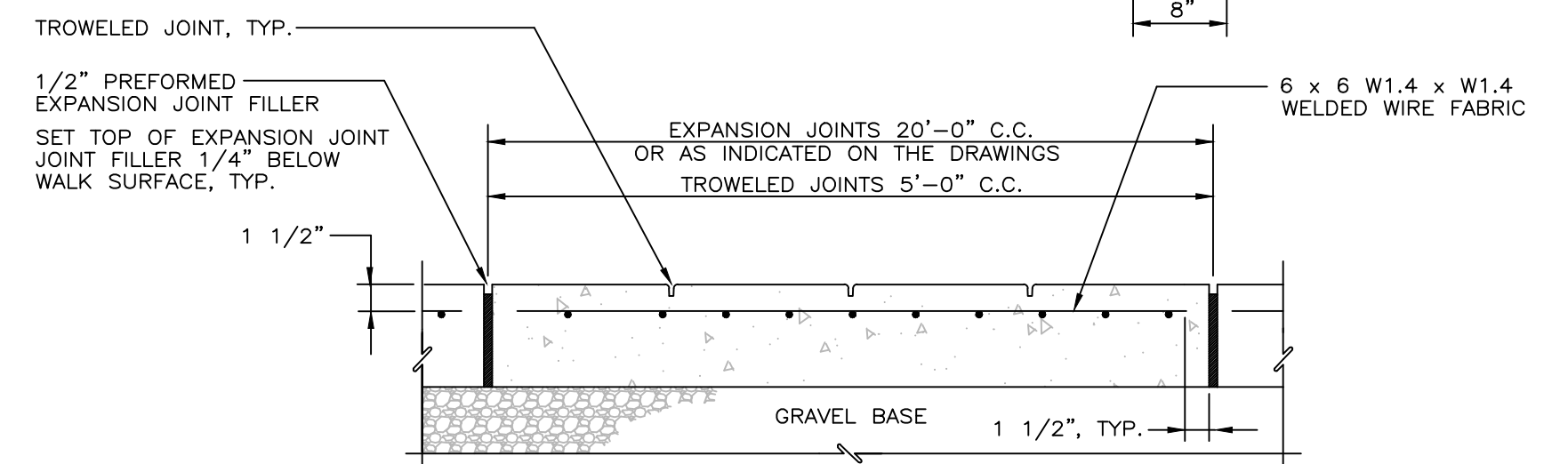

SECTION B-B

INTEGRAL CONCRETE SIDEWALK AND CURB
NOT TO SCALE

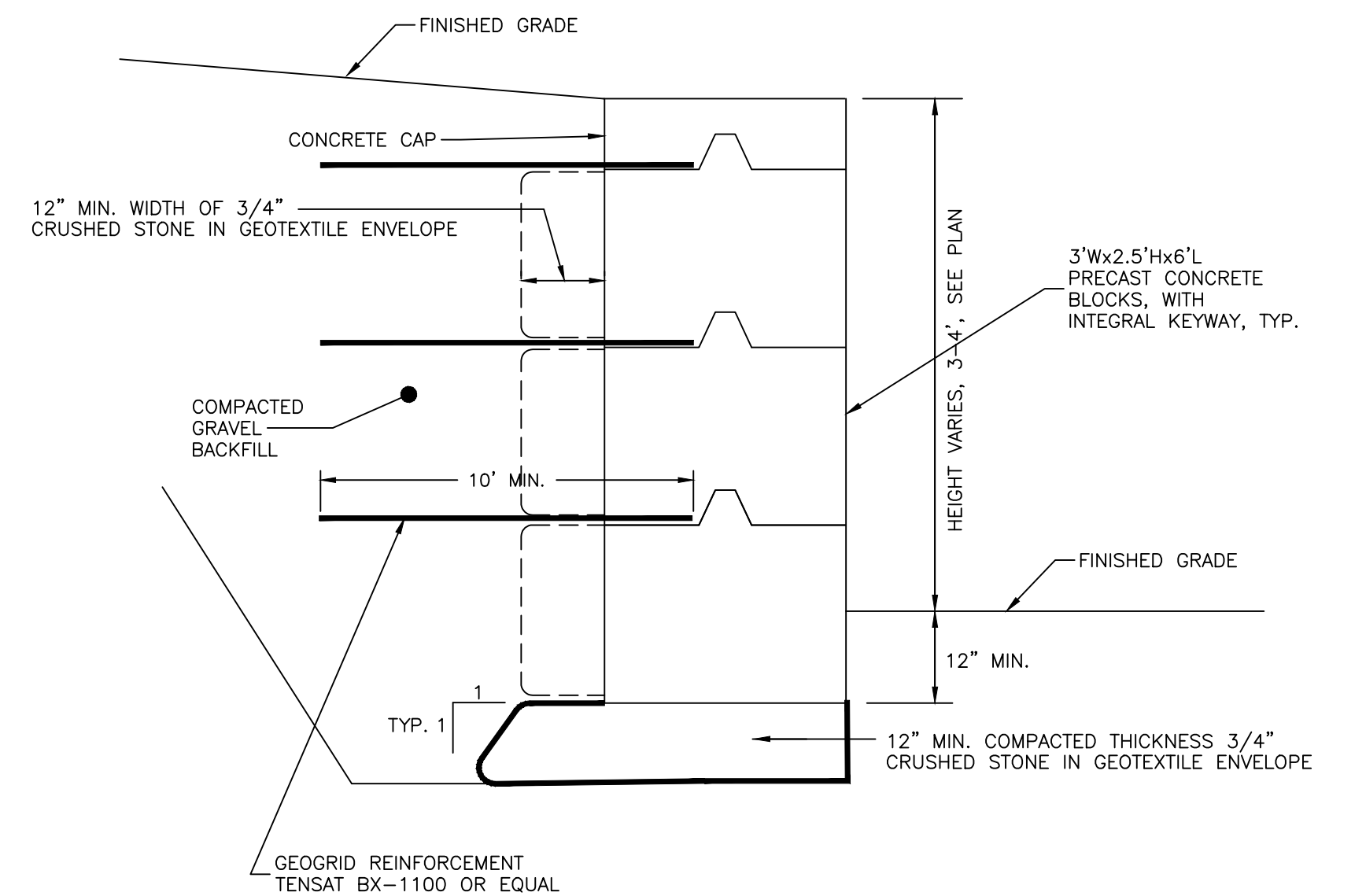

TYPICAL RETAINING WALL SECTION

<div><div><div>CRISCUOLO</div><div>ENGINEERING LLC</div></div><div><div>CONSULTING ENGINEERS</div><div>LAND SURVEYORS</div></div><div><div>420 East Main Street Building 1 - Suite 9 Branford, CT 06405 TEL: 203/481-0807 FAX: 203/488-5729</div></div></div> <td colspan="2"></td> <td colspan="2">JOB TITLE:</td> <td colspan="2">PROPERTY LOCATED AT #97 DEFCO PARK ROAD NORTH HAVEN, CONNECTICUT</td>			JOB TITLE:		PROPERTY LOCATED AT #97 DEFCO PARK ROAD NORTH HAVEN, CONNECTICUT	
			PREPARED FOR:		PRO-KLEAN	
	REV. DATE: DESCRIPTION:		DRAWING TITLE:		DRAWING NO.:	
			DATE: 2/19/2021		3	
			SCALE: AS SHOWN		OF	
		DRAWN: J.T.G.		4		
		CHECKED: J.M.P.		ASSESSOR'S MAP 95, LOT 27		
		JOB: 2020.051		CADD FILE: 2020-051P08		